

Decorative Border Craft Punch



Border Gauge

Set

2

1
Border Aid



Set

4
Decorative
Corner -
End Punch

3
Decorative
Border Craft
Punch

ITEM NO. :	CD-5
SIZE :	1 W97 x L128 x H70mm
	2 W366 x L85 x H53mm
WEIGHT / g :	1 303g
	2 153g

ITEM NO. :	CD-50
SIZE :	3 W80 x L51 x H34mm
	4 W80 x L51 x H34mm
WEIGHT / g :	3 240g
	4 240g



How to Punch

Step 1

Insert the paper until it fits into border gauge

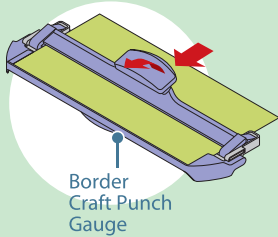

Border
Craft Punch
Gauge

Step 2

Insert decorative border craft punch into border aid

Lever
Decorative
Border
Craft Punch

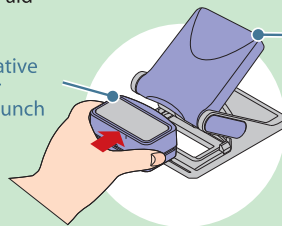

Border
Craft
Punch
Aid

Step 3

Set border aid with border gauge

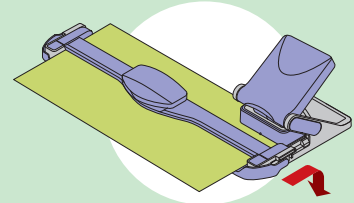

Step 4

Press lever down

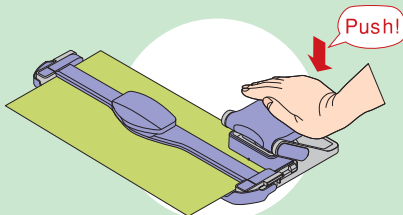

Step 5

Systematically punch using the special punch attachment

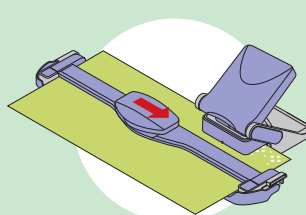

Step 6

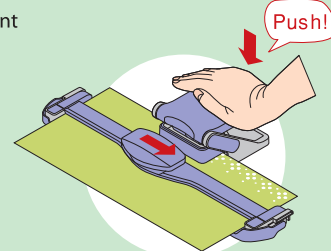

Decorative Border Craft Punch

Actual Size

Border



Corner



Border End



Pearl Dots

Punching Image

This image is carried by 50% reduction



Border



Corner



Border End



Mosaic Tile

Punching Image

This image is carried by 50% reduction



Border



Corner



Border End



Classical Leaf

Punching Image

This image is carried by 50% reduction



Border



Corner



Border End



Happy Clover

Punching Image

This image is carried by 50% reduction



Border



Corner



Border End



Fairy Ribbon

Punching Image

This image is carried by 50% reduction



Border



Corner



Border End



Twinkle Flowers

Punching Image

This image is carried by 50% reduction

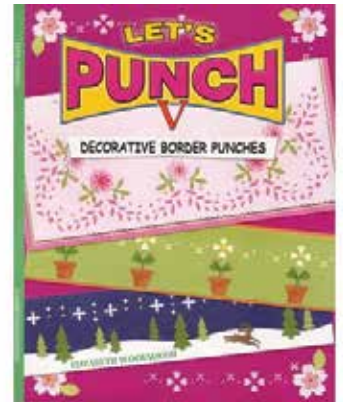

P-BOOK21

